

**RECEIVED**  
CLERK'S OFFICE

AUG 11 2005

STATE OF ILLINOIS  
Pollution Control Board

**BEFORE THE ILLINOIS POLLUTION CONTROL BOARD**

OKAWVILLE FARMERS ELEVATOR CO.     )  
(Property Identification Number     )  
12-06-20-478-013)     06-23  
Petitioner,     ) PCB -  
  ) (Tax Certification)  
ILLINOIS ENVIRONMENTAL     )  
PROTECTION AGENCY     )  
Respondent.     )

**NOTICE**

Dorothy M. Gunn, Clerk  
Illinois Pollution Control Board  
James R. Thompson Center  
100 West Randolph Street, Suite. 11-500  
Chicago, Illinois 60601

Dale Tippet  
702 S. Elevator St.  
Okawville, Illinois 62271

Steve Santarelli  
Illinois Department of Revenue  
101 West Jefferson  
Post Office Box 19033  
Springfield, Illinois 62794

**PLEASE TAKE NOTICE** that I have today filed with the Office of the Clerk of the Pollution Control Board an **APPEARANCE AND THE RECOMMENDATION** of the Illinois Environmental Protection Agency, a copy of which is herewith served upon you.

ENVIRONMENTAL PROTECTION AGENCY  
OF THE STATE OF ILLINOIS

By:   
James Allen Day  
Assistant Counsel  
Division of Legal Counsel

DATED: August 8, 2005  
Illinois Environmental Protection Agency  
1021 North Grand Avenue East  
Post Office Box 19276  
Springfield, Illinois 62794-9276  
217-782-5544

BEFORE THE ILLINOIS POLLUTION CONTROL BOARD AUG 11 2005

STATE OF ILLINOIS  
Pollution Control Board

OKAWVILLE FARMERS ELEVATOR CO. )  
(Property Identification Number )  
12-06-20-478-013 )  
Petitioner, ) PCB 06-23  
(Tax Certification)  
ILLINOIS ENVIRONMENTAL )  
PROTECTION AGENCY )  
Respondent. )

**A P P E A R A N C E**

The undersigned, as one of its attorneys, hereby enters an **APPEARANCE** on behalf of the Respondent, Illinois Environmental Protection Agency.

ENVIRONMENTAL PROTECTION  
AGENCY OF THE STATE OF ILLINOIS

By:   
James Allen Day  
Assistant Counsel  
Division of Legal Counsel

DATED: August 8, 2005

Illinois Environmental Protection Agency  
1021 North Grand Avenue East  
Post Office Box 19276  
Springfield, Illinois 62794-9276  
217-782-5544

**RECEIVED**  
CLERK'S OFFICE

**BEFORE THE ILLINOIS POLLUTION CONTROL BOARD**

OKAWVILLE FARMERS ELEVATOR CO.     )  
(Property Identification Number        )  
12-06-20-478-013)     06-23  
                    Petitioner,                ) PCB -

AUG 11 2005  
STATE OF ILLINOIS  
Pollution Control Board

ILLINOIS ENVIRONMENTAL                )  
PROTECTION AGENCY                    )  
                    Respondent.                )

) (Tax Certification)

**RECOMMENDATION**

Now Comes the Illinois Environmental Protection Agency ("Illinois EPA") by James Allen Day, one of its attorneys, and pursuant to Section 125.204 of the Illinois Pollution Control Board's (Board) regulations files the following Recommendation regarding the tax certification of water pollution control facilities pursuant to 35 Ill. Adm. Code 125.204.

- 1) On December 2, 2004, the Illinois EPA received a request from Okawville Farmers Elevator Co. for an Illinois EPA recommendation regarding the tax certification of water pollution control facilities pursuant to 35 Ill. Adm. Code 125.204, and noted the request as log number TC-29-04. (Exhibit A)
- 2) The person authorized to receive the requested certification is:  
  
Dale Tippet  
702 S. Elevator St.  
Okawville, Illinois 62271
- 3) The facility's location is:  
  
702 S. Elevator St.  
Okawville, Illinois 62271
- 4) The water pollution control facilities in this request are located at Section 20, Township 1 South, Range 4 West of the 3<sup>rd</sup> Principal Meridian in Washington County, Illinois at the

above street address and include the following two separate facilities for purposes of this recommendation:

(a) Agrichemical containment structures consisting of three (3) liquid agrichemical operational area containment structures; one (1) dry fertilizer blended with pesticide operational containment structure; two (2) bulk liquid agrichemical secondary containment structures; one (1) minibulk/package agrichemical secondary containment structure; associated collection and recovery systems; four (4) dry fertilizer operational containment structures; and the portion of the building over two (2) liquid agrichemical operational area containment structures, one (1) dry fertilizer blended with pesticide operational containment structure (14 ft. x 49 ft. x 0.25 ft.), and one (1) bulk liquid agrichemical secondary containment structure as approved under the Agency endorsed Agrichemical Facility Permit No. 92061506 (Log No. 02057075 issued July 24, 2002). (These facilities are further described in Exhibit A.)

(b) The portion of the building over the area for endloader transfer of bulk dry fertilizer between storage and the blenders measuring 43 feet by 43 feet. (These facilities are further described in Exhibit A.)

4. Section 11-10 of the Property Tax Code, 35 ILCS 200/11-10 (2000), defines “pollution control facilities” as: “any system, method, construction, device or appliance appurtenant thereto or any portion of any building or equipment, that is designed, constructed, installed or operated for the primary purpose of: (a) eliminating, preventing, or reducing

air or water pollution ...or (b) treating, pretreating, modifying or disposing of any potential solid, liquid or gaseous pollutant which if released without treatment, pretreatment modification or disposal might be harmful, detrimental or offensive to human, plant or animal life, or to property.”

5. Pollution control facilities are entitled to preferential tax treatment, 35 ILCS 200/11-5 (2000).
6. With respect to the facilities described in Paragraph 3(a) above (the containment structures), based on the information in the application and the purpose of the facilities (to collect, transport, and store agrichemical rinsates, residues, or washwaters prior to reuse or disposal), it is the Illinois EPA’s engineering judgment that the described facilities may be considered “pollution control facilities,” pursuant to 35 Ill. Adm. Code 125.200(a), with the primary purpose of eliminating, preventing, or reducing water pollution, or as otherwise provided in 35 Ill. Adm. Code 125.200. Therefore, the facilities are eligible for tax certification from the Board.
7. With respect to the facilities described in Paragraph 3(b) above (the portion of the building over the area for endloader transfer and blenders), based on the information in the application and the purpose of the facilities (to protect products from moisture), it is the Illinois EPA’s engineering judgment that the described facilities are not “pollution control facilities,” pursuant to 35 Ill. Adm. Code 125.200(a), with the primary purpose of eliminating, preventing, or reducing water pollution, or as otherwise provided in 35 Ill. Adm. Code 125.200. Therefore, the facilities are not eligible for tax certification from the Board.
8. Therefore, the Illinois EPA recommends that the Board issue the requested tax

certification for the facilities described in Paragraph 3(a) above (the containment structures) and deny the requested tax certification for the facilities described in Paragraph 3(b) above (the portion of the building over the area for endloader transfer and blenders).

Illinois Environmental Protection Agency

By:

  
James Allen Day  
Assistant Counsel  
Division of Legal Counsel

August 8, 2005

Illinois Environmental Protection Agency  
1021 North Grand Ave. E.  
P.O. Box 19276  
Springfield, Illinois 62794-9276  
217/782-5544

STATE OF ILLINOIS

COUNTY OF SANGAMON

)  
)  
)  
)  
)

**PROOF OF SERVICE**

I, the undersigned, on oath state that I have served the attached **APPEARANCE AND RECOMMENDATION**, upon the person to whom it is directed, by placing a copy in an envelope addressed to:

Dorothy M. Gunn, Clerk  
Illinois Pollution Control Board  
James R. Thompson Center  
100 West Randolph Street, Suite. 11-500  
Chicago, Illinois 60601

Dale Tippet  
702 S. Elevator St.  
Okawville, Illinois 62271

Steve Santarelli  
Illinois Department of Revenue  
101 West Jefferson  
Post Office Box 19033  
Springfield, Illinois 62794

and mailing it from Springfield, Illinois on **August 8, 2005** with sufficient postage affixed for first class mail.

*Nancy Lampert*

SUBSCRIBED AND SWORN TO BEFORE ME

this eighth day of August, 2005

*Brenda Boehner*  
Notary Public



## Watershed Land Use Certification Review sheet

Project Name: Okauchville Farmers Elevator Co.  
 Reviewer: JRA  
 Log No.: TC-29-04

Location: Okawville  
Date: 10 Jun 05  
Type: ☒ Agchem  
= Livestock

Applicant: Dale Tappett  
702 S. Elevator Street  
Okemville, IL 62271  
(618) 243-5293

Contact: Keith Honeygar  
Phone: (618) 656-8046

Facility: same

Property ID: 12-06-20-478-013

2221 Description: Sec 20 T1S R4W 3E PM.

Country: Washington

File Control: \_\_\_\_\_  
Devices installed: 1992

Provided  
Fair Cash  
Value: \$ 60,000

Signature: \_\_\_\_\_

**Title:** \_\_\_\_\_

Wastes: ☐ Livestock waste is applied to cropland.  
☒ Agrochemical rinsate and spillage is recycled through the facility and/or land applied.  
☐ Other: \_\_\_\_\_

Physical Description of Pollution Control Devices:

Other: \_\_\_\_\_



# AgChem

Project Name: Oklawaha Farmers Elevator Log No.: TC- 29-04

Permit Number: 92061506

02057076 issued July 24, 2002

Number	Description	Log Number
3	Liquid agrichemical operational area containment structures OC-1 44' x 60' x 0.07' conc - loading, unloading, washing (in) OC-2 12' x 24' x 0.07' conc - mixing (in) OC-3 11' x 13' x 0.05' conc - unloading	02057076
1	Dry fertilizer blended with pesticide operational containment structures 14' x 49' x 0.25' conc + 8' loading	02057076
2	Bulk liquid agrichemical secondary containment structures SC-1 27.33' x 47.33' x 2' conc - pest. (in) SC-2 41.33' x 51.33' x 4' conc - fert. (cont)	02057076
1	Minibulk/package agrichemical secondary containment structures SC-3 32' x 65.5' x 0.17' conc	02057076
The portion of the building over		
2	Liquid agrichemical operational area containment structures OC-1 OC-2	
1	Dry fertilizer blended with pesticide operational containment structures 14' x 45' x 0.25'	
1	Bulk liquid agrichemical secondary containment structures SC-1	
1	Dry fertilizer blending operational containment structures 43' x 43'	
1	Associated collection and recovery systems	02057076
4	Dry fertilizer operational containment structures 43' x 43' conc - one train b/w storage (88-1) & drums & unloading (in) 10' x 60' conc - unloading	02057076
—	Dry fertilizer blending operational containment structures 14' x 45' conc - one train b/w storage (88-1) & drums 31' x 32' conc - unloading	
—	Dry fertilizer aisleway operational containment structure	

Drawing

52

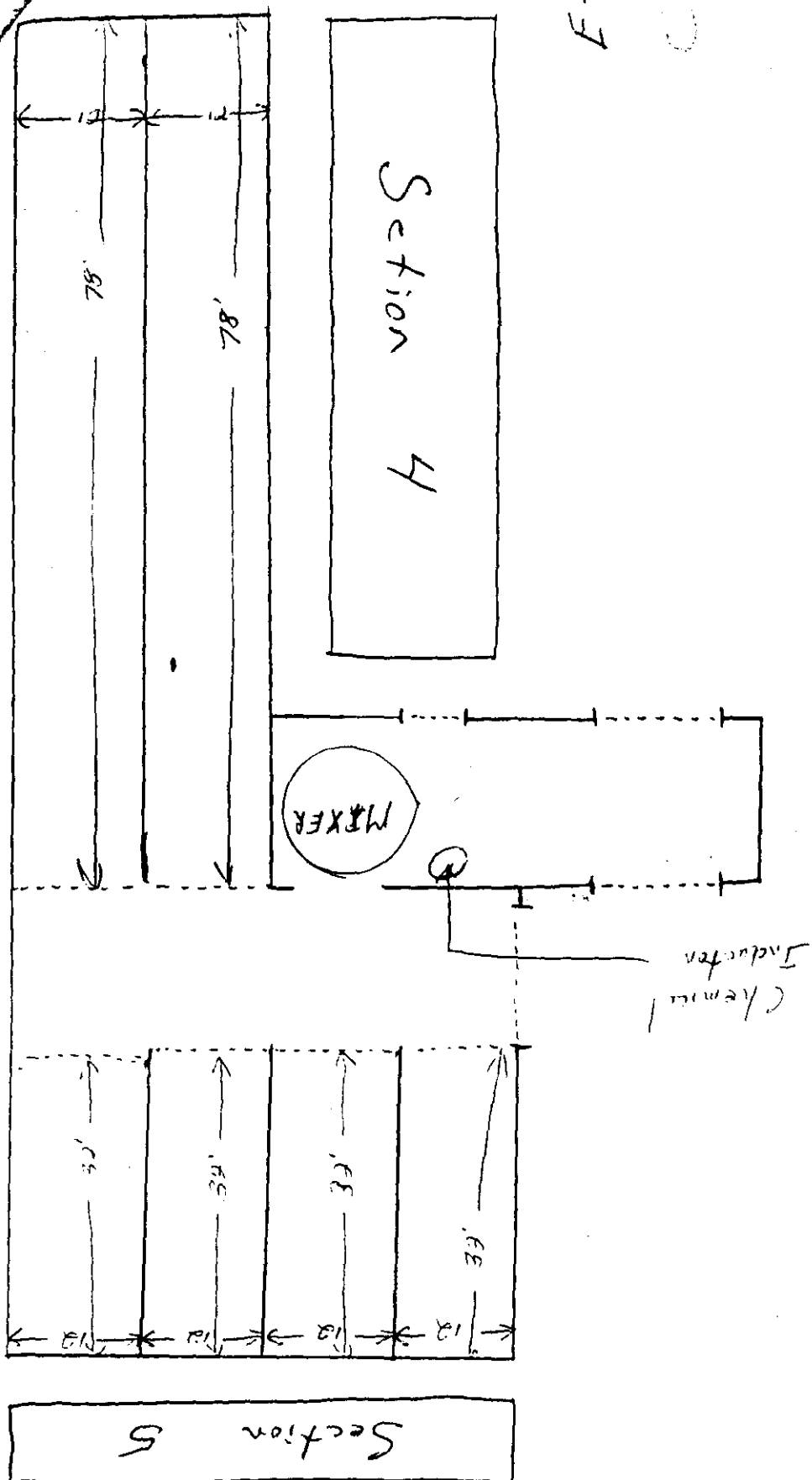

14

3

62

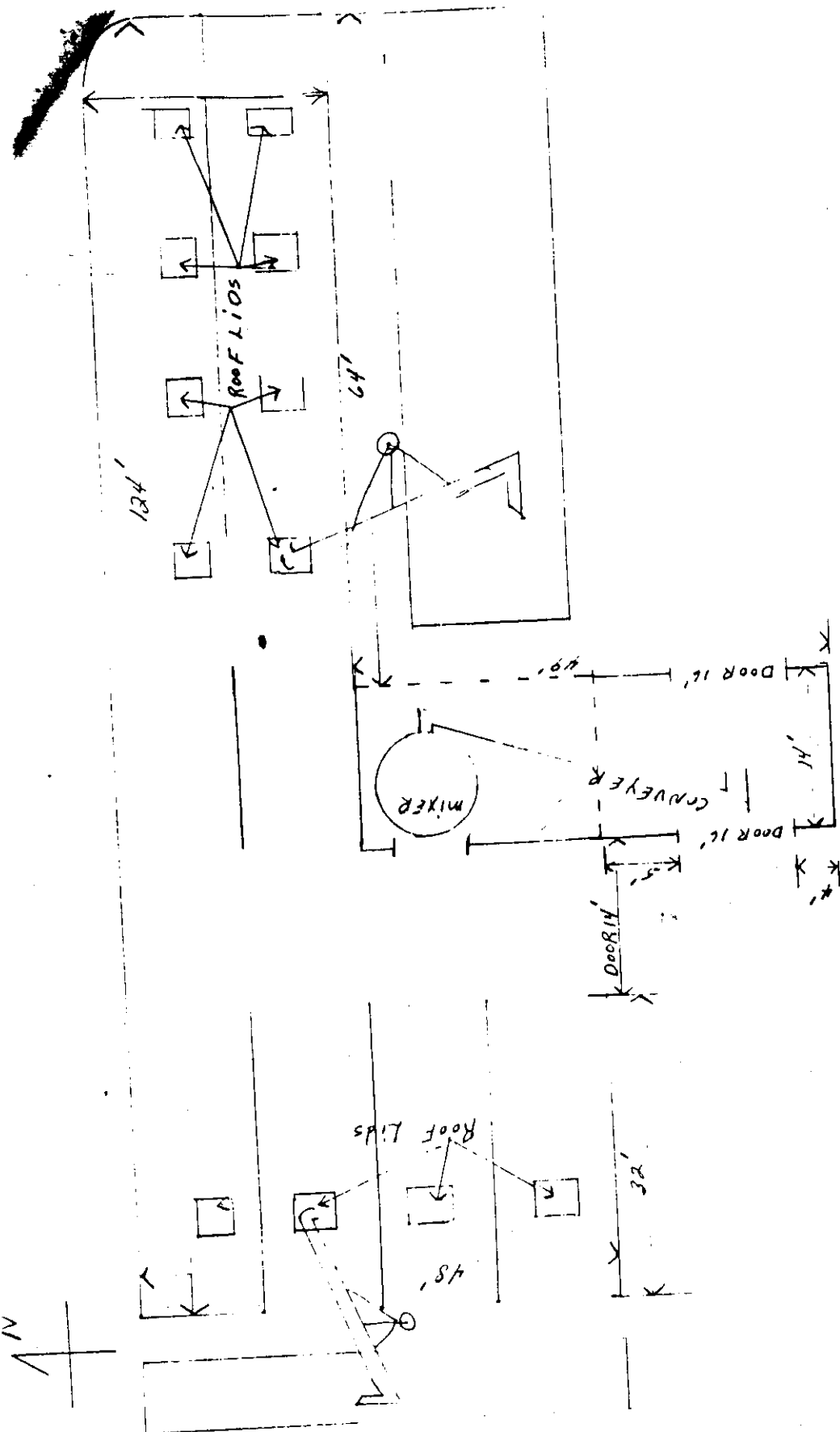

Don Hanko  
WPC - Collinsville  
APC - Collinsville

State of Illinois  
Department of Agriculture  
AGRICHEMICAL FACILITY PERMIT

DLH  
records  
binds

<b>Permittee:</b> Okawville Farmers Elevator Company PO Box 396 Okawville, IL 62271		<b>Facility ID Number:</b> AC1893070000 <b>Facility Location:</b> Okawville, IL	
<b>Permit #:</b> AC92061506	<b>Log Number:</b> 02057076	<b>Date Received:</b> May 17, 2002	<b>Expiration Date:</b> July 24, 2007
<b>Facility Type:</b> Commercial: Retail Dealer		<b>Date Issued:</b> July 24, 2002	

Permit is hereby granted to the above designated permittee to construct and operate an agrichemical containment facility as follows:

**OPERATIONAL CONTAINMENT STRUCTURES**

Operation of an existing reinforced concrete operational containment structure measuring 44' (width) x 60' (length) x 0.67' (depth) with a total design capacity of 796.0 cubic feet (ft.<sup>3</sup>). The floor shall slope to a series of four (4) sumps (two (2) for the separation of solids and two (2) for the recovery of liquids), each sump measuring 1.5' (diameter) x 2' (depth) to facilitate the collection and recovery of all escaped product and/or agrichemical wastewater. All recovered effluent shall be transferred to one (1) of two (2) 1600 gallon recovery tanks with a manually activated sump pump. Segregation shall be performed based upon the applicable target crop and label use. The loading, unloading and washing of bulk liquid agrichemical transportation and application shall be performed upon the herein permitted structure. This structure shall be referred to as OC-1.

Operation of an existing reinforced concrete operational containment structure measuring 12' (width) x 26.67' (length) x 4' (depth) with a total design capacity of 1280.0 cubic feet (ft.<sup>3</sup>). The floor shall slope to a single sump measuring 1.5' (diameter) x 2' (depth) to facilitate the collection and recovery of all escaped product and/or agrichemical wastewater. All recovered effluent shall be transferred to one (1) of the two (2) aforementioned 1600 gallon recovery tanks with a manually activated sump pump. Segregation shall be performed based upon the applicable target crop and label use. All mixing of liquid agrichemicals and the mixing liquid agrichemicals with soluble dry fertilizer shall be performed upon the herein permitted structure. This structure shall be referred to as OC-2.

**RECEIVED**

AUG 05 2002

Watershed Management Section  
BUREAU OF WATER



*State of Illinois*  
*Department of Agriculture*

Okawville Farmers Elevator Company

**AGRICHEMICAL FACILITY PERMIT**

Page 2

Operation of an existing reinforced concrete operational containment structure measuring 11' (width) x 13' (length) x 0.5' (depth) with a total design capacity of 37.0 cubic feet (ft.<sup>3</sup>). The floor shall slope to a single sump measuring 1.5' (diameter) x 2' (depth) to facilitate the collection and recovery of all escaped product and/or agrichemical wastewater. All recovered effluent shall be transferred to a single 29,613 gallon recovery tank with a manually activated sump pump. The unloading of bulk liquid agrichemical transportation and application equipment shall be performed upon the herein permitted structure. This structure shall be referred to as OC-3.

**SECONDARY CONTAINMENT STRUCTURES**

Operation of an existing reinforced concrete secondary containment structure measuring 27.33' (width) x 47.33' (length) x 2' (height) with a total design capacity of 1686.0 cubic feet (ft.<sup>3</sup>). The floor shall slope to a single sump measuring 1.5' (diameter) x 2' (depth) to facilitate the collection and recovery of all escaped product and/or agrichemical wastewater. All recovered effluent shall be transferred to one (1) of the two (2) aforementioned 1600 gallon recovery tanks with a manually activated sump pump. Segregation shall be performed based upon the applicable target crop and label use. All bulk liquid pesticides shall be stored within the said structure. This structure shall be referred to as SC-1.

Operation of an existing reinforced concrete secondary containment structure measuring 41.33' (width) x 51.33' (length) x 4' (height) with a total design capacity of 8496.0 cubic feet (ft.<sup>3</sup>). The floor shall slope to a single sump measuring 1.5' (diameter) x 2' (depth) to facilitate the collection and recovery of all escaped product and/or agrichemical wastewater. All recovered effluent shall be transferred to the aforementioned 29,613 gallon recovery tank with a manually activated sump pump. All bulk liquid fertilizer shall be stored within the said structure. This structure shall be referred to as SC-2.

Operation of an existing reinforced concrete secondary containment structure measuring 32' (width) x 65.5' (length) x 0.17' (height). The floor shall slope to the operational containment structure (OC-1) to facilitate the collection and recovery of all escaped product and/or agrichemical wastewater. All recovered effluent shall be transferred to one (1) of the two (2) 1600 gallon recovery tank with a manually activated sump pump. Segregation shall be performed based upon the applicable target crop and label use. Mini-bulk and packaged agrichemicals shall be stored within the said structure. This structure shall be referred to as SC-3.

**BULK DRY FERTILIZER STRUCTURES**

Operation of an existing bulk dry fertilizer storage building measuring 15' (width) x 39' (length) with an estimated total storage capacity of 125 tons. This structure shall be referred to as DB-1.



*State of Illinois*  
*Department of Agriculture*

Okawville Farmers Elevator Company

**AGRICHEMICAL FACILITY PERMIT**

Page 3

Operation of an existing bulk dry fertilizer storage building with the greatest dimensions measuring 73' (width) x 124' (length) with an estimated total storage capacity of 1100 tons. The structure shall be composed of six (6) storage bins (two (2) bins, each bin measuring 12' (width) x 78' (length) with an estimated storage capacity of 250 tons each, and four (4) bins, each bin measuring 12' (width) x 32' (length) with an estimated storage capacity of 150 tons each). This structure shall be referred to as **DB-2**.

All bulk dry fertilizer shall be stored within the herein permitted structure.

Operation of an existing reinforced concrete operational containment structure measuring 43' (width) x 43' (length). The endloader transfer of bulk dry fertilizer between storage (**DB-1**) and the blenders and the unloading of bulk dry fertilizer transportation and application equipment shall be performed upon the herein permitted structure.

Operation of an existing reinforced concrete operational containment structure measuring 10' (width) x 60' (length). The unloading of bulk dry fertilizer transportation and application equipment shall be performed upon the herein permitted structure.

Operation of an existing reinforced concrete operational containment structure measuring 14' (width) x 48' (length). The endloader transfer of bulk dry fertilizer between storage (**DB-2**) and the blender shall be performed upon the herein permitted structure.

Operation of an existing reinforced concrete operational containment structure measuring 5' (width) x 32' (length). The unloading of bulk dry fertilizer transportation and application equipment shall be performed upon the herein permitted structure.

Operation of an existing reinforced concrete operational containment structure measuring 14' (width) x 49' (length) x 0.25' (depth) with a total design capacity of 196.0 cubic feet (ft<sup>3</sup>). The floor shall slope to a single sump measuring 1' (diameter) x 3' (depth) to facilitate the collection and recovery of all escaped product and/or agrichemical wastewater. All recovered effluent shall be transferred to transportation and application equipment with a manually activated sump pump. Segregation shall be performed based upon the applicable target crop and label use. All blending of bulk dry fertilizer, including the impregnation of dry fertilizer with pesticides, and all loading of bulk dry fertilizer, including impregnated fertilizer shall be performed upon the herein permitted structure.

There shall be no discharge of wastewater from the herein permitted facilities.

This permit has been reviewed and approved by the Illinois Environmental Protection Agency per the attached permit endorsement. This permit is subject to standard conditions on the reverse side of this document and the following special conditions:

**SPECIAL CONDITION 1:** The permittee shall provide backflow protection in accordance with the Illinois Department of Public Health Plumbing Code (77 Ill. Adm. Code 890) and the Illinois Environmental Protection Agency's Technical Policy Statement (35 Ill. Adm. Code 653.803(c)(4)).



State of Illinois  
Department of Agriculture

Okawville Farmers Elevator Company

AGRICHEMICAL FACILITY PERMIT

Page 4

**SPECIAL CONDITION 2:** The permittee may discharge accumulated precipitation from the herein permitted bulk liquid fertilizer secondary containment structure (SC-2) and unloading containment structure (OC-3) pursuant to 8 Illinois Administrative Code 255.110 (a) (2) (A) and (B).

**SPECIAL CONDITION 3:** The permittee shall perform all operations involving the impregnation of bulk dry fertilizer with pesticides, in accordance with 8 Illinois Administrative Code 255.150. The permittee shall maintain and manage the operational containment structure employed for the pesticide inductor pursuant to 8 Illinois Administrative Code 255.90.

**SPECIAL CONDITION 4:** The permittee shall operate the exposed dry fertilizer operations pursuant to 8 Illinois Administrative Code 255.140 (a), (c) and (d).

**SPECIAL CONDITION 5:** The permittee shall employ a totally enclosed conveyor for the transfer of bulk dry fertilizer from the unloading containment structure and the bulk dry fertilizer storage building (DB-2).

THE STANDARD CONDITIONS OF ISSUANCE ON THE REVERSE SIDES OF THIS MUST BE COMPLIED WITH IN FULL.

*Warren D. Goetsch*

Warren D. Goetsch, P.E.  
Division Manager, Natural Resources

*Gerald C. Kirbach*

Gerald C. Kirbach, Manager  
Permits and Downstate Field Operations

cc: Illinois EPA: WPC: Permits  
file  
a:189307.per



TC-29-04

## APPLICATION FOR CERTIFICATION (PROPERTY TREATMENT)

POLLUTION CONTROL FACILITY

AIR ☐WATER ☒RECEIVED  
DEC 02 2004

This Agency is authorized to request this information under Illinois Revised Statutes, 1979, Chapter 20, Section 502a-5. Disclosure of this information is voluntary. However, failure to comply could prevent your application from being processed or could result in denial of your application for certification.

ILLINOIS ENVIRONMENTAL PROTECTION AGENCY

P. O. Box 19276, Springfield, IL 62794-9276

ILLINOIS ENVIRONMENTAL PROTECTION AGENCY

FOR AGENCY USE

BOW/WPC/PERMIT SECTION

File No. Date Received Certification No. Date 11/26/04

Sec. A APPLICANT	Company Name Okawville Farmers Elevator Co.			
	Person Authorized to Receive Certification Dale Tippet		Person to Contact for Additional Details Keith Honegger	
	Street Address 702 S. Elevator Street		Street Address 3200 Old Troy Road	
	Municipality, State & Zip Code Okawville, IL 62271		Municipality, State & Zip Code Glen Carbon, IL 62034	
	Telephone Number 618/243-5293		Telephone Number 618/656-8046	
	Location of Facility Quarter Section SEC 20 TWP 1S R4W		Municipality Okawville	
	Township Okawville		Range Okawville	
	Street Address 702 S. Elevator St. Odawville, IL		County Washington	
Property Identification Number 12-06-20-478-013		Book Number		
Sec. B MANUFACTURING OPERATIONS	Nature of Operations Conducted at the Above Location  Mixing, Loading, and Storing of Agrichemicals and Fertilizers			
	Water Pollution Control Construction Permit No. 92061506 Log# 02057076		Date Issued July 24, 2002	
	NPDES PERMIT No.		Date Issued	
	Air Pollution Control Construction Permit No.		Expiration Date	
	Air Pollution Control Operating Permit No.		Date Issued	
Sec. C MANUFACTURING PROCESS	Describe Unit Process			
	Materials Used in Process			
Sec. D POLLUTION CONTROL FACILITY DESCRIPTION	Describe Pollution Abatement Control Facility			
	<p>1) Agrichemical containment structure consisting of three agrichemical operational area containment structures (44' x 60' x .67'; 12' x 26.67' x 4'; 11' x 13' .5') and three secondary containment structures (27.33' x 47.33' x 2'; 41.33' x 51.33' x 4'; &amp; 32' x 65.5' x .17') and the building covering two operational containment structure (44' x 60' x .67' and 12' x 26.67' x 4') and two secondary containment structures (27.33' x 47.33' x 2'; and 41.33' x 51.33' x 4'). Five bulk fertilizer operational containment structures (43' x 43'; 10' x 60'; 14' x 48'; 5' x 32'; &amp; 14' x 49' x .25') and the building over the 14' x 49' x .25' containment area used for the blending of bulk dry fertilizer and the portion of the building over the operational containment area used for the conveyance of bulk dry fertilizer from storage to blending (43' x 43'); associated collection and recover systems as endorsed by Agrichemical Facility Permit No. 92061506 Log # 02057076.</p>			

IL 532-0222

APC 151 (Rev. 8/00)

blending (43' x 43'); associated collection and recover systems as endorsed by Agrichemical Facility Permit No.

92061506 Log # 02057076.

Page 1 of 2  
8/00





*State of Illinois*  
*Department of Agriculture*  
**AGRICHEMICAL FACILITY PERMIT**

<b>Permittee:</b> Okawville Farmers Elevator Company PO Box 396 Okawville, IL 62271	<b>Facility ID Number:</b> AC1893070000 <b>Facility Location:</b> Okawville, IL
<b>Permit #:</b> AC92061506 <b>Facility Type:</b> Commercial: Retail Dealer <b>Date Issued:</b> July 24, 2002	<b>Log Number:</b> 02057076 <b>Date Received:</b> May 17, 2002 <b>Expiration Date:</b> July 24, 2007

Permit is hereby granted to the above designated permittee to construct and operate an agrichemical containment facility as follows:

**OPERATIONAL CONTAINMENT STRUCTURES**

Operation of an existing reinforced concrete operational containment structure measuring 44' (width) x 60' (length) x 0.67' (depth) with a total design capacity of 796.0 cubic feet (ft.<sup>3</sup>). The floor shall slope to a series of four (4) sumps (two (2) for the separation of solids and two (2) for the recovery of liquids), each sump measuring 1.5' (diameter) x 2' (depth) to facilitate the collection and recovery of all escaped product and/or agrichemical wastewater. All recovered effluent shall be transferred to one (1) of two (2) 1600 gallon recovery tanks with a manually activated sump pump. Segregation shall be performed based upon the applicable target crop and label use. The loading, unloading and washing of bulk liquid agrichemical transportation and application shall be performed upon the herein permitted structure. This structure shall be referred to as OC-1.

Operation of an existing reinforced concrete operational containment structure measuring 12' (width) x 26.67' (length) x 4' (depth) with a total design capacity of 1280.0 cubic feet (ft.<sup>3</sup>). The floor shall slope to a single sump measuring 1.5' (diameter) x 2' (depth) to facilitate the collection and recovery of all escaped product and/or agrichemical wastewater. All recovered effluent shall be transferred to one (1) of the two (2) aforementioned 1600 gallon recovery tanks with a manually activated sump pump. Segregation shall be performed based upon the applicable target crop and label use. All mixing of liquid agrichemicals and the mixing liquid agrichemicals with soluble dry fertilizer shall be performed upon the herein permitted structure. This structure shall be referred to as OC-2.



**State of Illinois  
Department of Agriculture**

Okawville Farmers Elevator Co. **AGRICHEMICAL FACILITY PERMIT**

Page 2

Operation of an existing reinforced concrete operational containment structure measuring 11' (width) x 13' (length) x 0.5' (depth) with a total design capacity of 37.0 cubic feet (ft.<sup>3</sup>). The floor shall slope to a single sump measuring 1.5' (diameter) x 2' (depth) to facilitate the collection and recovery of all escaped product and/or agrichemical wastewater. All recovered effluent shall be transferred to a single 29,613 gallon recovery tank with a manually activated sump pump. The unloading of bulk liquid agrichemical transportation and application equipment shall be performed upon the herein permitted structure. This structure shall be referred to as OC-3.

**SECONDARY CONTAINMENT STRUCTURES**

Operation of an existing reinforced concrete secondary containment structure measuring 27.33' (width) x 47.33' (length) x 2' (height) with a total design capacity of 1686.0 cubic feet (ft.<sup>3</sup>). The floor shall slope to a single sump measuring 1.5' (diameter) x 2' (depth) to facilitate the collection and recovery of all escaped product and/or agrichemical wastewater. All recovered effluent shall be transferred to one (1) of the two (2) aforementioned 1600 gallon recovery tanks with a manually activated sump pump. Segregation shall be performed based upon the applicable target crop and label use. All bulk liquid pesticides shall be stored within the said structure. This structure shall be referred to as SC-1.

Operation of an existing reinforced concrete secondary containment structure measuring 41.33' (width) x 51.33' (length) x 4' (height) with a total design capacity of 8496.0 cubic feet (ft.<sup>3</sup>). The floor shall slope to a single sump measuring 1.5' (diameter) x 2' (depth) to facilitate the collection and recovery of all escaped product and/or agrichemical wastewater. All recovered effluent shall be transferred to the aforementioned 29,613 gallon recovery tank with a manually activated sump pump. All bulk liquid fertilizer shall be stored within the said structure. This structure shall be referred to as SC-2.

Operation of an existing reinforced concrete secondary containment structure measuring 32' (width) x 65.5' (length) x 0.17' (height). The floor shall slope to the operational containment structure (OC-1) to facilitate the collection and recovery of all escaped product and/or agrichemical wastewater. All recovered effluent shall be transferred to one (1) of the two (2) 1600 gallon recovery tank with a manually activated sump pump. Segregation shall be performed based upon the applicable target crop and label use. Mini-bulk and packaged agrichemicals shall be stored within the said structure. This structure shall be referred to as SC-3.

**BULK DRY FERTILIZER STRUCTURES**

Operation of an existing bulk dry fertilizer storage building measuring 15' (width) x 39' (length) with an estimated total storage capacity of 125 tons. This structure shall be referred to as DB-1.



*State of Illinois*  
*Department of Agriculture*

Okawville Farmers Elevator Co.

**AGRICHEMICAL FACILITY PERMIT**

Page 3

Operation of an existing bulk dry fertilizer storage building with the greatest dimensions measuring 73' (width) x 124' (length) with an estimated total storage capacity of 1100 tons. The structure shall be composed of six (6) storage bins (two (2) bins, each bin measuring 12' (width) x 78' (length) with an estimated storage capacity of 250 tons each, and four (4) bins, each bin measuring 12' (width) x 32' (length) with an estimated storage capacity of 150 tons each) This structure shall be referred to as DB-2.

All bulk dry fertilizer shall be stored within the herein permitted structure.

Operation of an existing reinforced concrete operational containment structure measuring 43' (width) x 43' (length). The endloader transfer of bulk dry fertilizer between storage (DB-1) and the blenders and the unloading of bulk dry fertilizer transportation and application equipment shall be performed upon the herein permitted structure.

Operation of an existing reinforced concrete operational containment structure measuring 10' (width) x 60' (length). The unloading of bulk dry fertilizer transportation and application equipment shall be performed upon the herein permitted structure.

Operation of an existing reinforced concrete operational containment structure measuring 14' (width) x 48' (length). The endloader transfer of bulk dry fertilizer between storage (DB-2) and the blender shall be performed upon the herein permitted structure.

Operation of an existing reinforced concrete operational containment structure measuring 5' (width) x 32' (length). The unloading of bulk dry fertilizer transportation and application equipment shall be performed upon the herein permitted structure.

Operation of an existing reinforced concrete operational containment structure measuring 14' (width) x 49' (length) x 0.25' (depth) with a total design capacity of 196.0 cubic feet (ft<sup>3</sup>). The floor shall slope to a single sump measuring 1' (diameter) x 3' (depth) to facilitate the collection and recovery of all escaped product and/or agrichemical wastewater. All recovered effluent shall be transferred to transportation and application equipment with a manually activated sump pump. Segregation shall be performed based upon the applicable target crop and label use. All blending of bulk dry fertilizer, including the impregnation of dry fertilizer with pesticides, and all loading of bulk dry fertilizer, including impregnated fertilizer shall be performed upon the herein permitted structure.

There shall be no discharge of wastewater from the herein permitted facilities.

This permit has been reviewed and approved by the Illinois Environmental Protection Agency per the attached permit endorsement. This permit is subject to standard conditions on the reverse side of this document and the following special conditions:

**SPECIAL CONDITION 1:** The permittee shall provide backflow protection in accordance with the Illinois Department of Public Health Plumbing Code (77 Ill. Adm. Code 890) and the Illinois Environmental Protection Agency's Technical Policy Statement (35 Ill. Adm. Code 653.803(c)(4)).



## (1) Nature of Contaminants or Pollutants

Contaminant or Pollutant	Material Retained, Captured or Recovered	
	DESCRIPTION	DISPOSAL OR USE
Fertilizer	Various Nitrogen, Phosphorus & Potash	Recycle

## (2) Point(s) of Waste Water Discharge

Plane and Specifications Attached		Yes	No <input checked="" type="checkbox"/>
(3)	Are contaminants (or residues) collected by the control facility?	Yes	No <input checked="" type="checkbox"/>
(4)	Date installation completed 1992	status of installation on date of application operational	
(5)	a. FAIR CASH VALUE IF CONSIDERED REAL PROPERTY:	\$	60,000
	b. NET SALVAGE VALUE IF CONSIDERED REAL PROPERTY:	\$	6,000
	c. PRODUCTIVE GROSS ANNUAL INCOME OF CONTROL FACILITY:	\$	0
	d. PRODUCTIVE NET ANNUAL INCOME OF CONTROL FACILITY:	\$	0
	e. PERCENTAGE CONTROL FACILITY BEARS TO WHOLE FACILITY VALUE:	%	100

The following information is submitted in accordance with the Illinois Property Tax Code, as amended, and to the best of my knowledge, is true and correct. The facilities claimed herein are "pollution control facilities" as defined in Section 11-10 of the Illinois Property Tax Code.

*Wale Tippett*  
Signature

*Ken Mays*  
Title

## INSTRUCTIONS FOR COMPILING AND FILING APPLICATION

**General:** Separate applications must be completed for each control facility claimed. Do not mix types (water and air). Where both air and water operations are related, file two applications. If attachments are needed, record them consecutively on an index sheet.

Sec. A	Information refers to applicant as listed in the tax records and the person to be contacted for further details or for inspection of facilities. Define facility location by street address or legal description. A plat map location is required for facilities located outside of municipal boundaries. The property identification number is required.		
Sec. B	Self-explanatory. Submit copies of all permits issued by local pollution control agencies. (e.g. MSD Construction Permit)		
Sec. C	Refers to manufacturing processes or materials on which pollution control facility is used.		
Sec. D	Narrative description of the pollution control facility, indicating that its primary purpose is to eliminate, prevent or reduce pollution. State the type of control facility. State permit number, date, and agency issuing permit. A narrative description and a process flow diagram describing the <u>pollution control facility</u> . Include a listing of each major piece of equipment included in the claimed fair cash value for real property. Include an <u>average</u> analysis of the influent and effluent of the control facility stating the collection efficiency.		
Sec. E	List air contaminants, or water pollution substances released as effluents to the manufacturing processes. List also the final disposal of any contaminants removed from the manufacturing processes. Item (1) – Refers to pollutants and contaminants removed from the process by the pollution control facility. Item (2) – Refers to water pollution but can apply to water-carried wastes from air pollution control facilities. Submit drawings, which clearly show (a) Point(s) of discharge to receiving stream, and (b) Sewers and process piping to and from the control facility. Item (3) – If the collected contaminants are disposed of other than as wastes, state the disposition of the materials, and the value in dollars reclaimed by sale or reuse of the collected substances. State the cost of reclamation and related expense. Item (4) – State the date which the pollution control facility was first placed in service and operated. If not, explain. Item (5) – This information is essential to the certification and assessment actions. This accounting data must be completed to activate project review prior to certification by this Agency.		
Sec. F	Self-explanatory. Signature must be a corporate authorized signature.		
	Submit to:	Attention:	Attention:
	Illinois EPA P.O. Box 19276 Springfield, IL 62794-9276	Thomas McSwiggin Permit Section Division of Water Pollution Control	Donald E. Sutton Permit Section Division of Air Pollution Control

**RECEIVED**  
JAN 24 2005

Watershed Management Section  
BUREAU OF WATER

file # TC 2904